

**MALLORY**

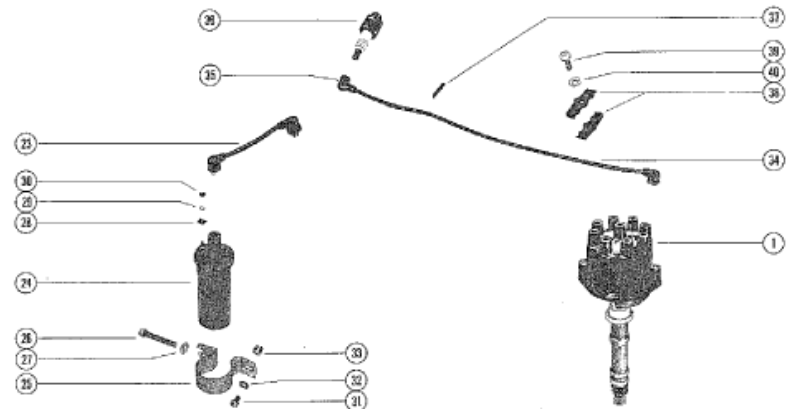

Parts List						
Ref	Class	Part	Description	Qty	Comment	Footnote
1	391	5071	DISTRIBUTOR ASSEMBLY, COM	1	LEFT HAND CRANKSHAFT ROT.	
1	391	5072	DISTRIBUTOR ASSEMBLY, COM	1	RIGHT HAND CRANKSHAFT RO	
2	391	5075	CAP, DISTRIBUTOR	1		
2	37	61593	DECAL, DISTRIBUTOR CAP	1		
3	391	5076	GASKET, DISTRIBUTOR CAP	1		
4	391	5088	ROTOR	1		
5	391	5092	CONDENSER	1		
6	391	5093	BRACKET, CONDENSER ATTAC	1		
7	391	5091	SCREW, CONDENSER BRACKE	1		
8	391	5090	BREAKER ASSEMBLY	1		
9	391	5089	SCREW, BREAKER ATTACHING	1		
10	391	5077	LEAD ASSEMBLY, PRIMARY	1		
11	391	5085	CLAMP, DISTRIBUTOR CAP AT	2		
12	391	5084	PIN, CLAMP TO DISTRIBUTOR	2		
13	391	5087	SCREW, DISTRIBUTOR CAP AT	2		
14	391	5086	WASHER, DISTRIBUTOR CAP	2		
15	391	5083	VENT, SCREEN	2		
16	391	5080	OILER	1		
17	391	5078	GEAR, DRIVE (LEFT HAND CRA	1		
17	391	5082	GEAR, DRIVE (RIGHT HAND CF	1		
18	391	5079	PIN, DRIVE GEAR	1		
19	391	5081	"O" RING, DISTRIBUTOR	1		4
20		58258	CLAMP, DISTRIBUTOR TO INTAK	1		
21	10	58259	SCREW, DISTRIBUTOR CLAMP	1		
22	13	58260	LOCKWASHER, DISTRIBUTOR C	1		
23	84	61891	LEAD ASSEMBLY, DISTRIBUTOR	1		
24		26433	COIL, IGNITION	1		
25		33321	BRACKET, IGNITION COIL MOUN	1		
26	10	33311	SCREW, BRACKET TO IGNITION	1		
27	13	35048	LOCKWASHER, BRACKET SCREW	1		
28	12	30164	WASHER, IGNITION COIL TERMI	2		
29	13	26996	LOCKWASHER, IGNITION COIL T	2		
30	11	20645	NUT, IGNITION COIL ATTACHING	2		
31	10	34613	SCREW, IGNITION COIL ATTACH	1		
32	12	20553	WASHER, IGNITION COIL ATTAC	1		
33	12	20553	SPACER, IGNITION COIL ATTACH	1		
34	84	61801A 4	LEAD ASSEMBLY, HIGH TENSIO	1		
34	84	61801A 7	LEAD ASSEMBLY, HIGH TENSIO	1		
34	84	61801A 3	LEAD ASSEMBLY, HIGH TENSIO	1		
34	84	61801A 6	LEAD ASSEMBLY, HIGH TENSIO	1		
34	84	61801A 2	LEAD ASSEMBLY, HIGH TENSIO	2		